PREMIUM LIST

AKC All-Breed AGILITY TRIALS
This Event is Accepting Entries for Mixed Breed Dogs
Enrolled in the AKC Canine Partners Program
TYLER OBEDIENCE TRAINING CLUB
(Licensed by the American Kennel Club)

April 30th, May 1st, 2nd 2021



LUCKY DOG TRAINING CENTER

County Road 1134 (Old Chandler Hwy) Tyler TX 75709
Event numbers: 2021269201, 2021269202, 2021269203
Friday, Saturday & Sunday – Apr 30th, May 1st, 2nd
Entry limits – 350 runs per judge, 350 runs per day
Walk thru begins at 8:15 AM on Friday, Saturday and Sunday
Trial Hours are Friday, Saturday & Sunday 7 AM until 6 PM

Judge: Lisa Jarvis
Entry Method: First Received

Equipment: Rubber contacts, plastic jump cups, electronic timing equipment and breakaway tire.

Air-conditioned/heated crating area & inside restroom – Covered Arena with packed dirt

ENTRIES WILL OPEN on March 1, 2021 at 8:00 AM at the Trial Secretary's address. All entries received before this date will be returned. Overnight or certified mail must be sent with the "No Signature Required" waiver signed.
ENTRIES WILL CLOSE ON 04/15, 2020 at 5:00 PM after which time entries cannot be accepted, cancelled, altered, or substituted except as provided for in Chapter 11, Section 6 of the Rules applying to Dog Shows. Envelopes/ transactions containing entries for more than the ten (10) maximum and/or entries received prior to the opening date shall be treated as invalid entry and shall be returned to the sender.



Permission is granted by the American Kennel Club for the holding of this event Under American Kennel Club Rules and Regulations.
James P. Crowley, Secretary

Tyler Obedience Training Club

Officers and Board

President.....Kathleen McCollough
 Tyler, TX

Vice-President.....Becky Barnes
 Golden, TX

Treasurer..... Sonja Asido
 Mineola, TX

Secretary..... Marcy Vail
 Mineola, TX

Event Committee

Kim Whaley, Monica Adkins, Cyndy Edwards, Cheryl Etheridge, Angela Hudson, & John Parsons

Trail Chairperson

Angela Hudson
 16361 Cattle Baron Dr
 Lindale, TX 75771
 Cell: 903-570-3852
 Zoemoppett1@yahoo.com

Trial Secretary

Monica Adkins
 7310 Sandy Hill Ln
 Murchison, TX 75778-2972
 Phone: 903-681-2458
 Maillady08@embarqmail.com

Judge and Assignment

Judge	(Fri)	(Sat)	Sun)
Lisa Jarvis Richardson, TX AKC#102206	Excellent/Masters, Open & Novice: Fast, Premier Standard, Standard, Premier JWW, JWW T2B	Excellent/Masters, Open & Novice: Fast, Premier Standard, Standard, Premier JWW, JWW T2B	Excellent/Masters, Open & Novice: Fast, Standard, JWW

Running Order Above

The above is tentative running order, a finalized running order will be emailed out upon closing. All classes will be run tall to small and walk through splits will be indicated in the final confirmation:

Check in Friday, Saturday & Sunday will be at 7 am – Walk thru at 8:15am

Please consult the AKC regulations for agility Trials for a complete description and eligibility for entry into these classes. The exhibitor is fully responsible for entering the dog in the correct class(es)/height divisions. Dogs running in a lower height division than they are eligible for will be eliminated.

Emergency Vet

On call Veterinarian: Tyler Animal Emergency Clinic -1401 W SW Southwest Loop 323 - Tyler TX 75701 (903)-534-0459

Height Divisions

REGULAR	PREFERRED	HEIGHT AT WITHERS
Handlers may opt to run their dog in a higher height division.	Handlers must run their dog in their proper eligible height.	Owners are responsible for entering their dog in the proper height division.
8"	4"	For dogs 11 inches and under at the withers
12"	8"	For dogs 14 inches and under at the withers
16"	12"	For dogs 18 inches and under at the withers
20"	16"	For dogs 22 inches and under at the withers
24"	20"	For dogs over 22 inches at the withers
24C"	n/a	Dogs under 22 inches may be entered at this height at their owner's discretion

Dogs Eligible to Enter

This trial is open to all dogs fifteen (15) months of age or older that are registered with the American Kennel Club or are registerable breeds that have obtained an AKC, ILP, or PAL number. Mixed breed dogs that have been listed with the AKC Canine Partners may participate provided their listings number has been recorded on the entry form. Dogs should be physically sound. Dogs that are blind or deaf shall not be eligible, and neither are bitches in season, aggressive dogs, or dogs suffering from any deformity, injury or illness which may affect the dog's physical or mental performance. No dog shall

compete if it is taped or bandaged in any way or has anything attached to it for medical purposes. Puppies under six months of age are strictly prohibited from the trial grounds.

Wait List Information

In the event the trial fills, we are offering a Wait List to fill openings created by withdrawn entries after the trial's closing date/time. A maximum of FIFTY (50) entries will be placed on the club's wait list. **All entries, including wait list entries, must be received by the Trial Secretary prior to the trial closing date as listed on the front of this Premium. Any withdrawals that are received by 6:00 pm the Sunday prior to the first day of the trial will be replaced by a wait list entry if any are available.** If a withdrawn entry is replaced by a wait list entry, a full refund will be issued for the withdrawn entry. Any wait listed entry that does not move off the wait list into the trial by 6:00 pm the Sunday prior to the first day of the trial will receive a full refund.

Obstacles and Ring Conditions

Obstacles will meet the specifications for obstacles in the current edition of the Regulations for Agility Trials. **All classes will take place in a covered arena on a packed dirt surface.** Ring measurement will be 90' W x 100' L

Entry Fees Per Day

- First Entry of each dog (includes \$3.50 AKC recording fee)\$23
 - Second Entry of same dog (includes a \$3.00 AKC recording fee)\$13
 - Third – sixth entry of same dog (includes \$3.00 AKC recording fee) \$13
- All confirmations will be emailed to a valid email address unless otherwise requested.

Mail entry forms and fees to: Monica Adkins 7310 Sandy Hill LN – Murchison, TX 75778-2972. Please make checks payable to: Tyler Obedience Training Club (or TOTC). No entries will be accepted by phone, fax, or hand delivery. Express mail entries must include the signature waiver allowing them to be left at the secretary's address. Inquiries may be directed to Monica Adkins at maillady08@embarqmail.com or agilitysecretaryAKC@tylerotc.org. No entry shall be made and no entry shall be accepted which specifies any conditions to its acceptance. Illegible entries will not be processed and will be returned to the exhibitor. Returned checks do not constitute a valid entry and the Trial Secretary will add a \$30.00 collection fee to the amount of each returned check.

Ribbons, Awards and Prizes

Strip ribbons will be awarded in each jump height division in each class as follows:

- First Place.....Blue*
- Second Place.....Red*
- Third Place.....Yellow*
- Fourth Place.....White*

Qualifying Score.....Dark Green

A New Title rosette will be awarded to all dog and handler teams finishing a title. A MACH/PACH rosette and MACH/PACH bar will be awarded to all dog and handler teams that attain their MACH/PACH.

All exhibitors should obtain a copy of the Regulations for Agility Trials by downloading them from the American Kennel Club website at <http://www.akc.org/rules/>.

NOTICE TO EXHIBITORS

SAFETY, BEHAVIOR AND LIABILITY

The safety of the dog is our primary concern. By entering this trial, exhibitors acknowledge that they are familiar with the rules and regulations of this sport, and their dogs are familiar with and able to perform all obstacles safely.

It is expressly understood that exhibitors alone are responsible for the behavior of their dogs and/or children. Any exhibitor whose dogs and/or children create an unnecessary disturbance or repeatedly engage in unsafe or disruptive behavior may, at the discretion of the trial committee, be asked to leave the show site.

All dogs must be on leash at all times when on trial grounds except when in the designated warm-up area or competing on the course.

AVMA: Exhibitors should follow their veterinarian's recommendations to assure their dogs are free of internal and external parasites, any communicable diseases, and have appropriate vaccinations.

REFUNDS

No entry fee will be refunded if the trial cannot open or be completed by reason of riots, civil disturbances, fire, an act of God, public emergency, act of a public enemy, or any other cause beyond the control of the organizing committee. No entry fee will be refunded in the event a dog is absent, disqualified, excused, or barred from competition by the action of the Trial Committee. Bitches in season are not permitted to compete in Agility Trials. As such, the club will refund the full amount of the entry fee paid for bitches unable to compete for this reason upon presentation of a veterinarian certificate. This certificate must be presented to the Trial Secretary prior to the start of judging on the first day of the trial or cluster of trials. The club will refund entry fees minus \$4.00 per run for an injured dog provided a veterinarian certificate is presented to the trial secretary prior to the start of judging on the first day of the trial.

RINGSIDE

Dogs may arrive any time prior to judging, if the dog does not need to be measured. Otherwise, they must be available for measuring prior to the start of their class. Judges are not required to wait for dogs. The Owner of each dog is solely responsible for having it ready at ringside when it is to be judged. The Club has no responsibility for providing service through a public address system or stewards or runners for the purpose of calling or locating dogs that are not brought into the ring when required.

This club does not agree to arbitrate claims as set forth on the Official AKC Entry Form for this event.

MOVE UPS

Move ups must be submitted in writing (email is fine) no later than Monday, April 26th, 2021 at 5pm. Contact Monica at maillady08@embarqmail.com or agilitysecretaryAKC@tylerotc.org.

Day-to-day move ups will be allowed. Exhibitors must present the move-up form to the trail secretary no later than 30 minutes after the trial ends each day.

HOTELS AND MOTELS THAT ACCEPT DOGS

Since hotel policies are subject to change, please be sure to inquire about current policies when making reservations. All hotels are within 15 minutes of the Lucky Dog Training Center.

La Quinta Inn & Suites by Wyndham McDonald Rd/University Tyler, TX 75701 903-481-9880	Baymont Inn & Suites 3913 Frankston Hwy Tyler TX 75701 903-939-0100 Dog Charge \$5 per dog Ask for the Lucky Dog Training Center Rate	La Quinta Inn- Tyler 2552 S SE Loop 323 Tyler, TX 75701 903-525-9677 NOT RECOMMENDED	La Quinta Inn & Suites by Wyndham 6702 S Broadway Ave Tyler, TX 75703 903-561-0863 *Great food choices walking distance
--	---	---	---

Other Information

Food

Several fast food restaurants within 3 miles of show site. No other on-site food vendors.

Worker Raffle

A worker raffle will be offered: each worker will receive raffle tickets to be used for items in the raffle and drawn each day.



AMERICAN
KENNEL CLUB®

OFFICIAL AMERICAN KENNEL CLUB AGILITY ENTRY FORM

Tyler Obedience Training Center – Tyler, TX

Opens: Mar 1st, 2021 8:00am CST • Closes: Apr 15th, 2021 5:00 pm CST

Apr 30, 2021	<input type="checkbox"/> PRM STD	<input type="checkbox"/> STD	<input type="checkbox"/> PRM JWW	<input type="checkbox"/> JWW	<input type="checkbox"/> T2B	<input type="checkbox"/> FAST
May 1, 2021	<input type="checkbox"/> PRM STD	<input type="checkbox"/> STD	<input type="checkbox"/> PRM JWW	<input type="checkbox"/> JWW	<input type="checkbox"/> T2B	<input type="checkbox"/> FAST
May 2, 2021		<input type="checkbox"/> STD		<input type="checkbox"/> JWW		<input type="checkbox"/> FAST

Daily Entry Fee: 1st run \$23; \$13 each additional run

Make checks payable to ~~TOTC~~; Mail to: Monica Adkins – 7310 Sandy Hill Ln – Murchison, TX 75778

IMPORTANT: Carefully read instructions before filling out!

ENTRY FEE ENCLOSED

Choose Either Regular OR Preferred Classes

Circle one jump height, and circle class selections: Only one selection per class (STD, JWW, FAST, T2B, Premier)

REGULAR Classes						PREFERRED Classes				
8"	12"	16"	20"	24"	24C"	4"	8"	12"	16"	20"
STD	Nov A	Nov B	Open	Exc	Master	STD	NovP	OpenP	ExcP	MasterP
JWW	Nov A	Nov B	Open	Exc	Master	JWW	NovP	OpenP	ExcP	MasterP
FAST	Nov A	Nov B	Open	Exc	Master	FAST	NovP	OpenP	ExcP	MasterP
T2B	T2B					T2B	T2B			
Premier JWW						Premier JWW P				
Premier Standard						Premier Standard P				

Non-Regular Classes International Sweepstakes STD JWW Select: 14" 18" 24"

This Dog Needs To Be Measured <input type="checkbox"/> Yes <input type="checkbox"/> No		SEX	HEIGHT AT WITHERS
BREED	VARIETY	CALL NAME	

AKC® NAME (INCLUDE AKC TITLES ONLY)

AKC® NO <input type="checkbox"/>	Enter Complete Registration # below	DATE OF BIRTH
ILP NO. <input type="checkbox"/>	PAL NO. <input type="checkbox"/>	PLACE OF BIRTH (LIST COUNTRY)
FOREIGN REG. NO & COUNTRY <input type="checkbox"/>	BREEDER	

SIRE

DAM

ACTUAL OWNERS

OWNERS ADDRESS

NEW ADDRESS

CITY, STATE, ZIP + 4

HANDLER

ENTER_IB, HANDLER # if applicable

Exhibitor or owner MUST sign on the signature line beneath the instructions.

AKC Rules, Regulations, Policies and Guidelines are available on the American Kennel Club Web site, www.akc.org.

AGREEMENT

I (we) agree that the club holding this event has the right to refuse entry for cause which the club shall deem sufficient. In consideration of the acceptance of this entry and of the holding of this event and of the opportunity to have the dog judged and to win prizes, ribbons, or trophies, I (we) agree to hold the AKC, the event-giving club, their members, directors, governors, officers, agents, superintendents or event secretary and the owner and/or lessor of the premises and any provider of services that are necessary to hold this event and any employees or volunteers of the aforementioned parties, and any AKC approved judge, judging at this event, harmless from any claim for loss or injury which may be alleged to have been caused directly or indirectly to any person or thing by the act of this dog while in or about the event premises or grounds or near any entrance thereto, and I (we) personally assume all responsibility and liability for any such claim; and I (we) further agree to hold the aforementioned parties harmless from any claim for loss, injury or damage to this dog.

Additionally, I (we) hereby assume the sole responsibility for and agree to indemnify, defend, and save the aforementioned parties harmless from any and all loss and expense (including legal fees) by reason of the liability imposed by law upon any of the aforementioned parties for damage because of bodily injuries, including death at any time resulting therefrom, sustained by any person or persons, including myself (ourselves), or on account of damage to property, arising out of or in consequence of my (our) participation in this event, however such, injuries, death or property damage may be caused, and whether or not the same may have been caused or may be alleged to have been caused by negligence of the aforementioned parties or any of their employees or agents, or any other persons.

I (WE) AGREE THAT ANY CAUSE OF ACTION, CONTROVERSY OR CLAIM ARISING OUT OF OR RELATED TO THE ENTRY, EXHIBITION OR ATTENDANCE AT THE EVENT BETWEEN THE AKC AND THE EVENT-GIVING CLUB (UNLESS OTHERWISE STATED IN ITS PREMIUM LIST) AND MYSELF (OURSELVES) OR AS TO THE CONSTRUCTION, INTREPRETATION AND EFFECT OF THIS AGREEMENT SHALL BE SETTLED BY ARBITRATION PURSUANT TO THE APPLICABLE RULES OF THE AMERICAN ARBITRATION ASSOCIATION. HOWEVER, PRIOR TO ARBITRATION ALL APPLICABLE AKC BYLAWS, RULES, REGULATIONS AND PROCEDURES MUST FIRST BE FOLLOWED AS SET FORTH IN THE AKC CHARTER AND BYLAWS, RULES, REGULATIONS, PUBLISHED POLICIES AND GUIDELINES.

INSTRUCTIONS

Handlers may opt to enter in a higher height division for all Regular titling classes, but not in a division lower than their proper height division. Dogs entered in the Preferred classes must compete at the required jump height and may not compete in a jump height division higher or lower than their proper height division.

All dogs that have not been officially measured for an Agility Jump Height Card may still compete; however, they must be measured by a Judge of record, an Agility Field Representative, or a Volunteer Measuring Official, prior to running. If measured by the Judge of record, that measurement will be valid for this trial or back-to-back trials only. If a measurement is necessary, it is the exhibitor's responsibility to have their dog(s) measured prior to running.

Dogs listed in the AKC Canine PartnersSM program may be eligible to enter all-breed AKC agility trials at the club's option. These dogs should be listed as All American Dog and must include their AKC number on the entry form and check the AKC No. box.

Junior Handlers should enter their Junior Handler number on the front of this form. Should you not have your Junior Handler number, it may be obtained from the American Kennel Club (919) 233-9767. If the Junior Handler is not the owner of the dog identified on the face of this form, what is the relationship of the Junior Handler to the Owner? _____

I CERTIFY that I am the actual owner of the dog, or that I am the duly authorized agent of the actual owner whose name I have entered above. In consideration of the acceptance of this entry, I (we) agree to abide by the rules and regulations of the American Kennel Club in effect at the time of this event, and by any additional rules and regulations appearing in the premium list for this event, and further agree to be bound by the "Agreement" printed on the reverse side of this entry form. I (we) certify and represent that the dog entered is not a hazard to persons or other dogs. This entry is submitted for acceptance on the foregoing representation and agreement. I (we) agree to conduct myself (ourselves) in accordance with all such Rules and Regulations (including all provisions applying to discipline) and to abide by any decisions made in accord with them.

SIGNATURE of owner or his agent duly authorized to make this entry.

SIGN HERE X _____

Telephone Number: _____

Email Address: _____ New Email

In Case of Emergency - Name: _____ Phone #: _____

Class Changes Effective January 1, 2020

Entering a Mixture of Regular and Preferred Classes Within the Same Trial Weekend – Multiple Jump Heights Within the Same Trial Day

Effective January 1, 2020, exhibitors may enter a mixture of both Regular and Preferred classes on the same trial day and/or during a trial weekend. Any mixture of Regular and Preferred classes is allowed. Please note that if a dog qualifies in Regular Master Standard and Preferred Master JWW (or vice versa) on the same trial day, then NO Double Q shall be earned toward either the MACH or PACH title. The Double Q still requires that Standard Agility and Jumpers With Weaves be either both Regular OR both Preferred on the same trial day.

Additionally, within the same Regular or Preferred classes, a dog may now be entered in multiple jump heights within the same trial day. For example, the same dog may now be entered in 20-inch Master STD/JWW while also entered in 24C-inch Premier STD/JWW on the same trial day.

A separate entry form must be submitted when the same dog is being entered in a mixture of Regular and Preferred and/or different jump heights within the same trial weekend thereby clearly indicating which class(es) and/or jump heights belong together for each trial day of the weekend.

Entering For Exhibition Only (FEO)

As of January 1, 2020, For Exhibition Only may be offered at the option of the host club. FEO will be offered on a one-year pilot basis in order to give AKC time to evaluate its impact. FEO will allow exhibitors to work with their dogs in a trial environment. FEO is only allowed in the Time 2 Beat and FAST classes. FEO will be of value to new exhibitors or exhibitors that are having difficulty with a specific obstacle and/or ring environment. Competitors must enter in T2B and/or FAST. Participation in FEO is non-qualifying.

- FEO runs are treated as trial entries. The exhibitor must enter the class(es) (T2B and/or FAST) prior to the closing date, pay class entry fee(s) and the Trial Secretary must record the entry in the Trial Catalog as part of the results for that class. FEO does not need to be noted on the entry form; the handler will declare the day of the show.
- Dogs may be entered in any jump height for FEO runs. If entered in an ineligible jump height, the team is committed to FEO for that run and must declare FEO on the start line. Day of show jump height changes are not allowed.
- Dogs may be entered in any level of FAST (Novice, Open, Excellent, Master). If the dog is not eligible for the level entered, the team is committed to FEO for that run and must declare FEO on the start line. Day of show level changes are not allowed.
- The exhibitor must declare FEO in the ring prior to leading out. FEO may be declared earlier (ex. when checking in at the gate board).
- Toys are allowed in the ring
 - Toys must be non-audible
 - Toys may not leave the handler's hand
 - Toys that roll freely cannot be used
- Food/treats are not allowed in the ring

- FEO should be utilized for the benefit of the dog and not as a punitive correction. Harsh verbal and /or physical corrections shall not be tolerated. Any determination of harshness by the judge shall be immediately whistled and the handler will be dismissed from the ring.
- A judge must monitor the entire run. Judges can stop a run at any time

Fix and Go On (FNG)

As of January 1, 2020, Fix and Go On will be offered on a one-year pilot basis in order to give AKC time to evaluate its impact. FNG allows exhibitors to immediately reattempt an obstacle at any time while on course when the dog's performance of an obstacle is not to their expectation. This allows the dog to successfully complete the obstacle then finish the course or leave the ring on a positive note. Using FNG will result in a non-qualifying score.

Fix and Go On is not pre-entered; rather, it occurs during the course of the run.

Directions to Lucky Dog:

Directions:

from Tyler - Follow Loop 323 around to the west side of town. Take Spur 364 (west) to CR 1134 (across from the Tire Barn). Turn south on CR 1134, go 2 miles, park is on left.

from north or east of downtown Tyler - take Loop 323 around the north side to HWY 31 west (headed to Chandler/Athens). Turn left on Spur 364 (the light just past Scott's plant). Climb hill, turn south (right) on CR 1134, go 2 miles, park is on left.

from south of LOOP 49 - take 155 to CR 2661. Turn west on 2661, go 9 miles. After crossing the railroad tracks, turn north on CR 1134. Go 0.8 miles, park is on right.

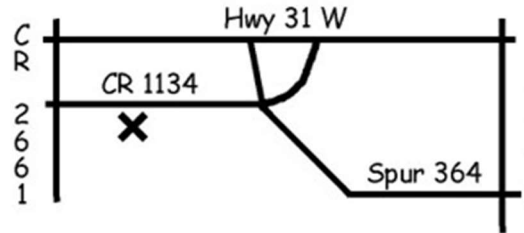

***** NOTE *****
For most GPS directions type in
"Old Chandler Hwy" instead of CR1134 -
then list address of 15545.